

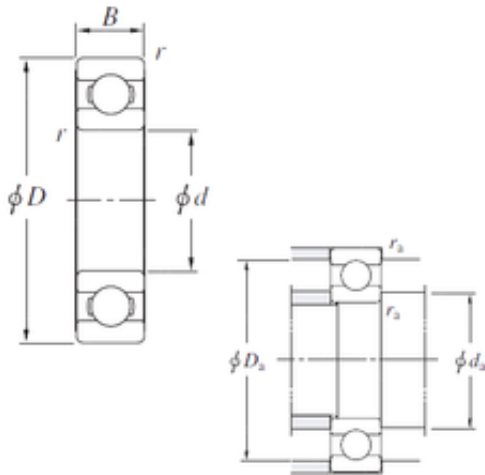

Bearing Import and Export Co., Ltd.



480 mm x 600 mm x 56 mm KOYO 6896 Single-row deep groove ball bearings

Bearing No. 6896

6896 Bearing 2D drawings and 3D CAD models

Size	480x600x56 mm
Bore Diameter	480 mm
Outer Diameter	600 mm
Width	56 mm
d	480 mm
D	600 mm
B	56 mm
C	56 mm
r min.	3 mm
da min.	493 mm
Da max.	587 mm
ra max.	2,5 mm
Weight	36,5 Kg
Basic dynamic load rating (C)	321 kN
Basic static load rating (C0)	539 kN
(Grease) Lubrication Speed	690 r/min
(Oil) Lubrication Speed	820 r/min
Bearing No.	6896
r(min)	3
Cr	401
C0r	539
Cu	12.0
f0	16.1
Grease lub.	690
Oil lub.	820



Bearing Import and Export Co., Ltd.

da(min)	493
Da(max)	587
ra(max)	2.5
(Refer.)Mass(kg)	36.5